

CLAY COUNTY, FLORIDA MOCCASIN SLOUGH PARK PHASE II CONSTRUCTION PLANS

PROJECT LOCATION

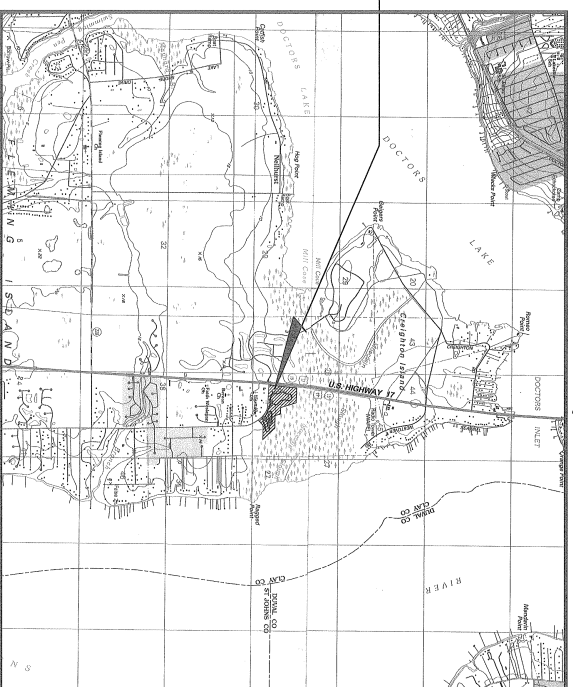

VICINITY MAP
NOT TO SCALE



PREPARED BY:

**THE R-AM PROFESSIONAL GROUP, INC.**
CIVIL AND ELECTRICAL ENGINEERING - LANDSCAPE ARCHITECTURE
8298 BAYBERRY ROAD - JACKSONVILLE, FL 32256 - (904) 731-5440
CERT. OF AUTH. 00006489 - CERT. OF AUTH. 26000197

ENGINEER OF RECORD: FRANK E. GRAY, P.E., FLA. REG. NO. 43053



PREPARED FOR:
**CLAY COUNTY
RECREATION AND PARKS
DEPARTMENT**

JANUARY, 2009