



Submittal Comments

Item No: 220523-01
(CSI No:)

Item
Descript: General Duty Valves for Plumbing Piping

Re: **Submittal** Comments
Cascade Science Lab Renovation
2008-046.CSL 8.3

Architecture
Engineering
Technology
Interior Design
Landscape Architecture

Wil-Fra-Mar Building
320 East Vermont Street
Indianapolis IN 46204-1640
317.263.6226
317.263.6224 (fax)
www.schmidt-arch.com

Reviewed and checked only for conformance with design concepts and with the information given in the Contract Documents. Approval does not release the Contractor from the responsibility to provide appropriate quantities, field measurements, dimensional stability, installation, anchorage, and coordination with other trades or release the Contractor from responsibility for deviations from the requirements of the Contract Documents or from responsibility for errors and omissions contained thereon.

X	Reviewed as Submitted - No Resubmittal Required.
	Reviewed as Noted - No Resubmittal Required.
	Reviewed as Noted - Revise and Resubmit.
	Rejected - Revise and Resubmit.
	Not Required for Review - Returned.
By: Michael Perry	
Date: May 8, 2009	

Comments

Copy: File

Tricia L. Smith

From: ken meiring [kenmeiring@kpmeiring.com]
Sent: Wednesday, April 22, 2009 9:28 PM
To: Tricia L. Smith
Subject: Cascade Science Lab Renovation Submittal
Attachments: 220523 - General Duty Valves for Plumbing.pdf

Hello Trish,

Attached is Submittal for Section 220523 - General Duty Valves for Plumbing

Kenneth P. Meiring
KP Meiring Company
6519 North Carrollton Avenue
Indianapolis, IN 46220-1616
(317) 257 7506 x 3
(317) 254 1305 fax
kenmeiring@kpmeiring.com
www.kpmeiring.com

Class 150 Bronze Gate Valves

Bolted Bonnet • Rising Stem • Solid Wedge

150 PSI/10.3 Bar Saturated Steam to 366° F/185° C
300 PSI/20.7 Bar Non-Shock Cold Working Pressure

CONFORMS TO MSS SP-80

MATERIAL LIST

PART	SPECIFICATION
1. Handwheel Nut	300 Series Stainless Steel
2. Identification Plate	Aluminum
3. Handwheel	Aluminum Commercial Alloy 380
4. Stem	Silicon Bronze ASTM B 371 Alloy C69400/C69430
5. Packing Nut	Bronze ASTM B 62 or ASTM B 584 Alloy C84400 or Brass ASTM B 16
6. Packing Gland	Bronze ASTM B 62 or ASTM B 584 Alloy C84400 or Brass ASTM B 16
7. Packing	Aramid Fibers with Graphite
8. Bonnet	Bronze ASTM B 62
9. Bonnet Bolt	Zinc Plated Steel
10. Bonnet Gasket	Aramid Fibers with Graphite
11. Wedge	Bronze ASTM B 62
12. Body	Bronze ASTM B 62

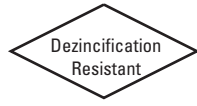

T-134
Threaded

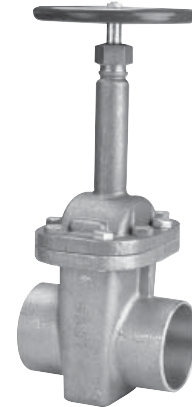

S-134
Solder

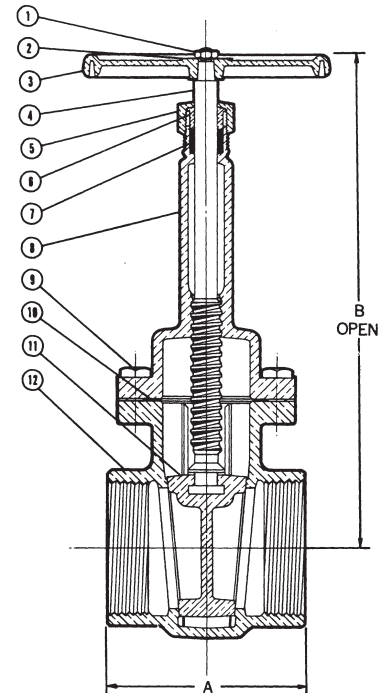

T-134
NPT x NPT

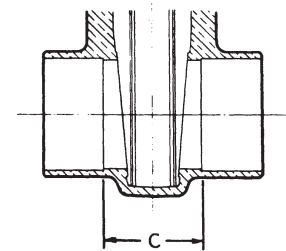

S-134
C x C

DIMENSIONS—WEIGHTS—QUANTITIES

Size	Dimensions						T-134		S-134		Master Ctn. Qty	
	In.	mm.	In.	mm.	In.	mm.	Lbs.	Kg.	Lbs.	Kg.		
4	100	6.44	164	20.81	529	3.56	90	45.68	20.72	43.96	19.94	1

K.P. MEIRING CO *KPM*
 CHECKED BY: _____
 DATE CHECKED: April 22, 2009
 REVIEWED NO EXCEPTIONS: _____ XX
 REVIEWED WITH EXCEPTIONS: _____
 REJECTED RESUBMIT: _____
 The review is only for general conformance with design concepts given in the contract documents. Subcontractor is responsible for dimensions, quantities, coordination with other trades and performing his work in a safe manner. No change to contract requirements is intended.

Freezing Weather Precaution – Subsequent to testing a piping system, valves should be in an open position to allow complete drainage.

◆ For detailed Operating Pressure, refer to Pressure Temperature Chart on page 110.

Brass Ball Valves

Two-Piece Body • Full Port • Blowout-Proof Stem • TFE Seats

1/4"-2" 600 PSI/41.4 Bar Non-Shock Cold Working Pressure
2 1/2"-4" 400 PSI/27.6 Bar Non-Shock Cold Working Pressure

CONFORMS TO MSS SP-110

AGA 3-88 • CGA • CR 91-002 • UL SUBJECT 258 • FM APPROVED

MATERIAL LIST

PART	SPECIFICATION
1. Handle	Steel, Plated
2. Nut, Handle	Steel, Plated
3. Pack Gland	Brass ASTM B 16 Alloy C36000
4. Packing, Stem	Virgin PTFE
5. Washer, Flat	430 Stainless
6. O-Ring (Stem Seal)	Fluorocarbon (FKM)
7. Washer, Thrust	Reinforced PTFE
8. Stem	1/4" - 1" & 2 1/2" - 4" 1 1/4" - 2" Brass ASTM B 16 Alloy C36000 Silicone Bronze ASTM B 371 Alloy 69400 or 69430
9. Body	Forged Brass ASTM B 283 Alloy C37700
10. Seat Ring	Virgin PTFE
11. Ball	1/4" - 3/4" & 2 1/2" - 4" 1" - 2" Chrome Plated Brass ASTM B 16 Alloy C36000 Chrome Plated Forged Brass ASTM 283 Alloy C37700
12. End Piece	Forged Brass ASTM B 283 Alloy C37700

Note: AGA, CGA, FM and UL approvals for T-FP-600 1/2"-2" only.
CSA is now the approving agency for AGA and CGA standards.
Meets Dimensional Requirements of MSS SP110

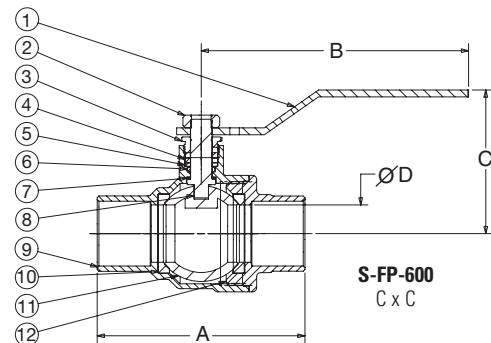
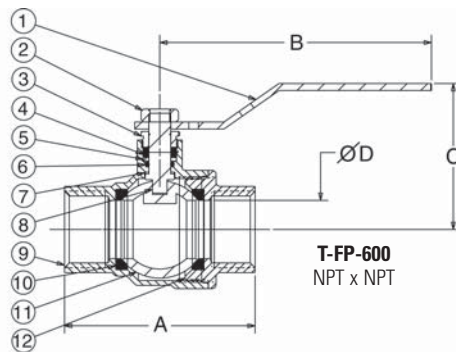
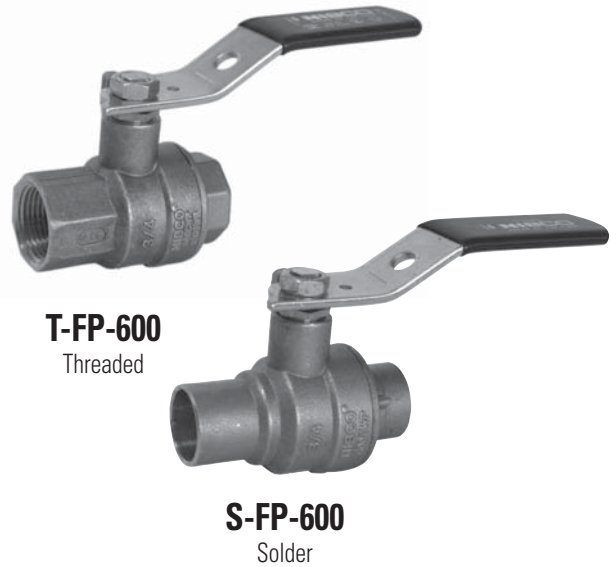

DIMENSIONS—WEIGHTS—QUANTITIES

Dimensions																					
Size	T-FP-600		S-FP-600		T-FP-600		S-FP-600		T-FP-600		S-FP-600		Port								
	In.	mm.	In.	mm.	In.	mm.	In.	mm.	In.	mm.	In.	mm.	Lbs.	Kg.							
1/4	8	1.98	50	—	—	3.90	99	—	—	1.95	49	—	—	.31	8	.52	.24	—	—	24	—
3/8	10	1.98	50	2.02	51	3.90	99	3.90	99	1.95	49	1.95	49	.38	10	.49	.22	.46	.21	24	14
1/2	15	2.22	56	2.15	55	3.34	85	3.90	99	1.95	49	1.95	49	.50	13	.53	.24	.48	.22	18	18
3/4	20	2.66	67	2.94	75	3.34	85	4.66	118	2.30	58	2.30	58	.75	19	.96	.44	.90	.41	12	12
1	25	3.27	83	3.62	92	4.13	105	4.66	118	2.50	64	2.50	64	1.00	25	1.32	.60	1.25	.57	6	6
1 1/4	32	3.66	93	4.08	104	4.13	105	6.69	170	3.07	78	3.05	77	1.25	32	2.27	1.03	2.14	.97	4	4
1 1/2	40	3.96	100	4.63	118	5.13	130	6.69	170	3.25	83	3.23	82	1.50	38	3.12	1.42	2.94	1.33	2	2
2	50	4.66	118	5.78	147	5.13	130	6.69	170	3.55	90	3.55	90	2.00	51	4.52	2.05	4.46	2.02	2	2
2 1/2	65	5.56	141	6.38	162	9.44	240	9.90	252	4.25	108	4.25	108	2.50	64	7.00	3.18	7.30	3.32	5	1
3	75	6.38	162	7.36	187	9.44	240	9.90	252	5.00	127	4.65	118	3.00	76	9.40	4.27	10.40	7.73	4	1
4	100	7.75	197	—	—	9.44	240	—	—	5.25	140	—	—	4.00	102	16.50	7.49	—	—	4	—

